

SECTION B - B

STANDARD SIZES and PRODUCT NUMBERS

DOOR SIZE	FRAMED OPENING	PRODUCT NUMBER	No. PADDLE LATCHES	MASONRY ANCHORS
8 X 8	8-1/2 X 8-1/2	3217-010-9	1	4
12 X 12	12-1/2 X 12-1/2	3217-012-9	1	4
12 X 24	12-1/2 X 24-1/2	3217-012-9	1	4
14 X 14	14-1/2 X 14-1/2	3217-014-9	1	4
16 X 16	16-1/2 X 16-1/2	3217-016-9	1	4
18 X 18	18-1/2 X 18-1/2	3217-018-9	1	4
22 X 30	22-1/2 X 30-1/2	3217-022-9	1	4
22 X 36	22-1/2 X 36-1/2	3217-027-9	1	4
24 X 24	24-1/2 X 24-1/2	3217-024-9	1	4
24 X 30	24-1/2 X 30-1/2	3217-023-9	1	4
24 X 36	24-1/2 X 36-1/2	3217-028-9	1	4
24 X 48*	24-1/2 X 48-1/2	3217-031-9	2	6
30 X 30*	30-1/2 X 30-1/2	3217-030-9	1	4
32 X 32*	32-1/2 X 32-1/2	3217-032-9	1	4
36 X 36*	36-1/2 X 36-1/2	3217-036-9	1	4
36 X 48*	36-1/2 X 48-1/2	3217-038-9	2	6
48 X 48*	48-1/2 X 48-1/2	3217-048-9	2	8

* - INTENDED FOR VERTICAL (WALL) APPLICATION ONLY
 NOTE: STAINLESS STEEL FIRE-RATED DOORS ARE AVAILABLE IN A MAXIMUM DIMENSION OF 36"

VERIFICATION AND APPROVAL OF GENERAL ARRANGEMENT AND OVERALL DIMENSIONS OF THIS DOCUMENT ARE REQUIRED BEFORE THE ORDER IS ENTERED FOR MANUFACTURING.

APPROVAL SIGNATURE _____ DATE OF APPROVAL _____
 TITLE HELD _____

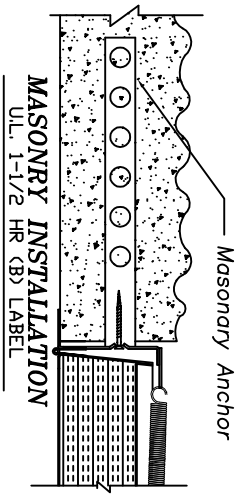
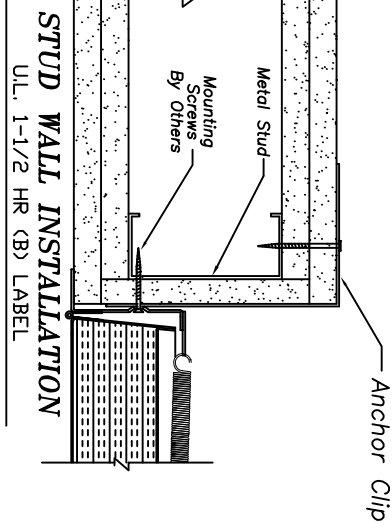

Three Hour Rated Non-combustible Floor/Ceiling Installation.

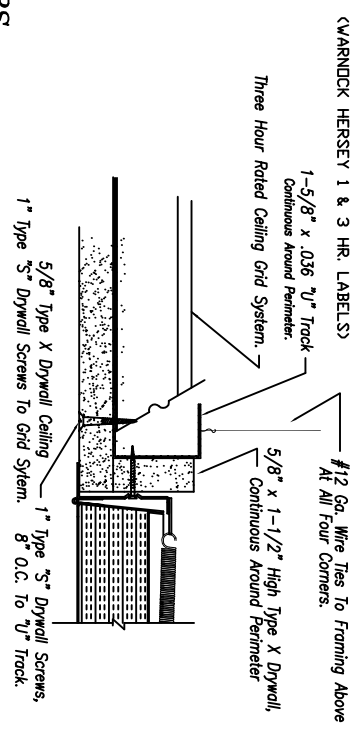

THESE DOORS HAVE BEEN TESTED AND PASSED THE UL10B 1-1/2 HOUR TEST AND WARNDOCK HERSEY 1 & 3 HOUR TESTS. THEY CARRY BOTH THE UL10B & WARNDOCK LABELS. ANY CHANGES REQUIRE THEIR APPROVAL OR NO LABELS CAN BE ADDED.

* POWDER COATED GRAY

THIS DRAWING IS THE PROPERTY OF COMMERCIAL PRODUCTS GROUP AND CONTAINS PROPRIETARY INFORMATION. NOT TO BE REPRODUCED OR REDISTRIBUTED WITHOUT CPG'S WRITTEN PRIOR CONSENT.



5030 Corporate Exchange Blvd. SE, Grand Rapids, MI 49512
 PH.: 800-624-8642 FAX: 855-549-2674 www.milcorinc.com

MILCOR. UFR-DW ACCESS DOOR

UNIVERSAL FIRED RATED DOOR FOR DRYWALL MATERIAL SCHEDULE

PART NO.	SIZE	COVER	FRAME
SUBMITTAL	W' X H'	20 GA.	16 GA.
DATE	12/14/16	DRAWN JM	
REV		JOB NO.	
		SHEET 1 of 1	